

Accessories

Technical characteristics

Material (accessories) Steel, zinc plated

Technical characteristics

RoHS compliant with exemption

Identification

Part number

Drawing
(dimensions in mm)

Coding,
With code pins,
Han® B

09 30 000 9901



Please order 4 pieces for one connector.

Han-Modular®,
Coding,
With code pins

09 14 000 9901



Please order 4 pieces for one connector.

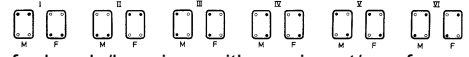
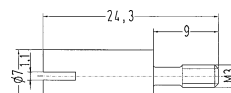
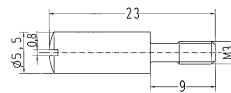

for hoods/housings with one insert/one frame

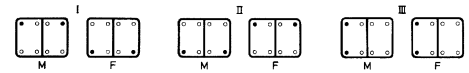

for hoods/housings with two inserts/two frames

- ◆ Code pin
- + Fixing screw
- M - male insert
- F - female insert