



Locking element for hoods and housings

### Features

- Cable to cable connection simple to realize and easy to mount
- Resistant elastomer
- Locking as well as seal combined in one system
- Protection degree IP65 in locked position
- For two lever locking system

### Technical characteristics

Material	NBR
Colour	black
Limiting temperatures	-40 °C ... +85 °C
Protection degree acc. to DIN EN 60 529 in locked position	IP65

Identification	Part-Number	Size	Drawing	Dimensions in mm
----------------	-------------	------	---------	------------------

#### Han® Hood Link

for Han® B standard hoods



09 30 016 9901

16 B

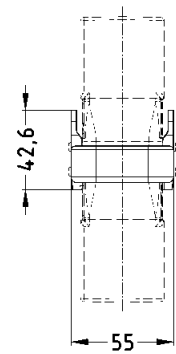
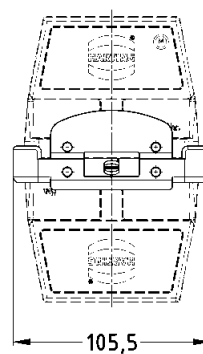

#### Han® Hood Link

for Han® B surface mounted housings  
bulkhead mounted housings  
and cable to cable hoods



09 30 016 9801

16 B

