

Number of contacts

24 + 7

F + H

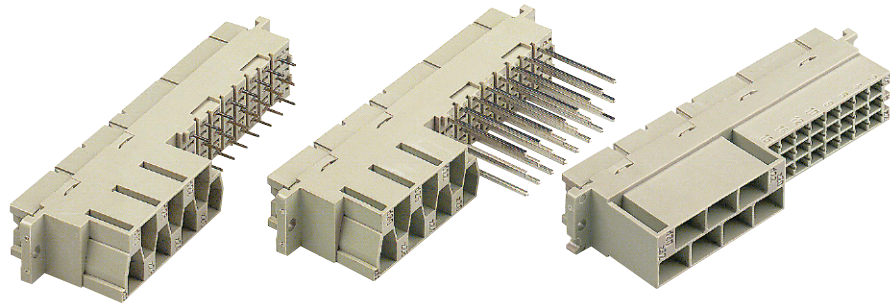

Female connectors

Identification	No. of contacts	Part number	Performance levels according to IEC 60 603-2. Explanation chapter 00		
			3	2	1
Female connector with solder pins 4.5 mm ¹⁾	24 + 7			09 06 231 6822	09 06 231 2822
Female connector with wrap posts 1 x 1 mm ¹⁾	24 + 7			09 06 231 6821	09 06 231 2821
Female connector for crimp contacts ¹⁾ Order contacts separately, see chapter 03	24 + 7				09 06 231 2881 09 06 231 2881 222 ²⁾

DIN Power up to 15 A

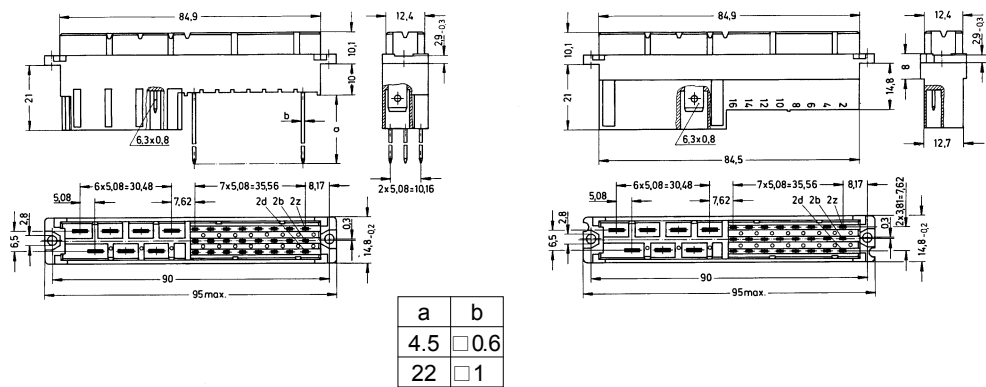

Panel cut out

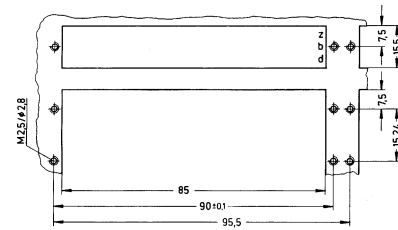

Board drillings
Mounting side

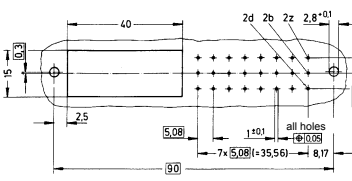

Contact arrangement
View from termination side

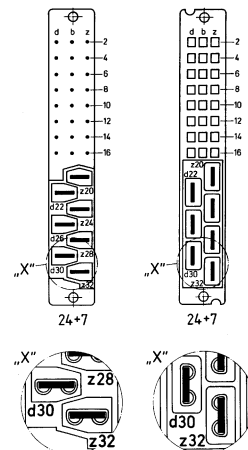

Shell housing for female connector with crimp contacts see chapter 20

Dimensions in mm

¹⁾ With shroud coding, see chapter 00
²⁾ Railway classification NFF 16-101, Smoke index: F1, Flammability class: I2