

Han® PushPull, type acc. to IEC 61076-3-117 variant 14
Housing bulkhead mounting for device integration and RJ45 jacks

Features

- HARTING PushPull technology
- Compact design
- High packing density
- Device integration via RJ45 PCB connectors

Technical characteristics

Locking	PushPull technology acc. to IEC 61076-3-117
Degree of protection	IP65 / IP67
Mating face	RJ45 acc. to IEC 60603-7
Termination type	Jack with solder termination
Mating cycles	min. 750
Temperature range	-40 °C ... +70 °C
Housing material	Plastic, black
Flammability acc. to UL 94	V0

Identification

Part number

Drawing

Dimensions in mm

Components device side

Housing bulkhead mounting plastic

09 35 002 0321

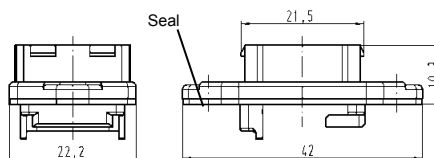

Panel cut out

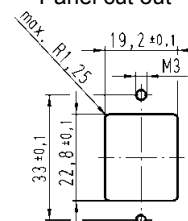

Protection cover IP65 / IP67

09 35 002 5402

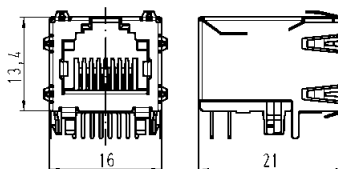

PCB layout

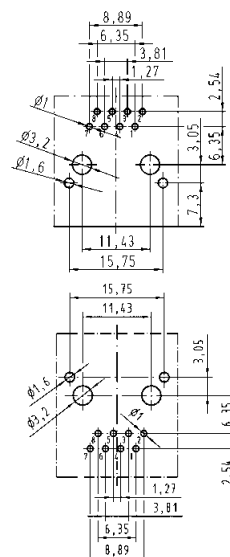

RJ45 jack

Solder variant, 90° angled

09 35 002 2101¹⁾

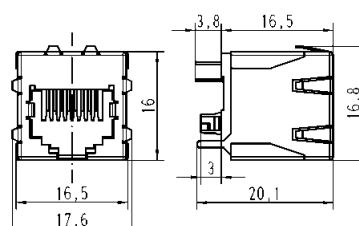

Solder variant, 180° straight

09 35 002 2102²⁾

¹⁾ Packaging: Blister à 90 pieces

²⁾ Packaging: Blister à 100 pieces