

Modular

Identification	Conductor cross-section (mm ²)	Part number	
		Male	Female
Han E®, Crimp contact, Contact surface: Silver plated	0.14 ... 0.37	09 33 000 6127	09 33 000 6227
	0.5	09 33 000 6121	09 33 000 6220
	0.75	09 33 000 6114	09 33 000 6214
	1	09 33 000 6105	09 33 000 6205
	1.5	09 33 000 6104	09 33 000 6204
	2.5	09 33 000 6102	09 33 000 6202
	3	09 33 000 6106	09 33 000 6206
	4	09 33 000 6107	09 33 000 6207

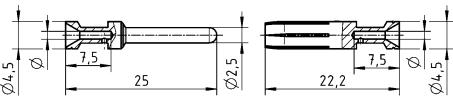

Identification	Conductor cross-section (mm ²)	Part number	
		Male	Female
Han E®, Crimp contact, Contact surface: Gold plated	0.14 ... 0.37	09 33 000 6117	09 33 000 6217
	0.5	09 33 000 6122	09 33 000 6222
	0.75	09 33 000 6115	09 33 000 6215
	1	09 33 000 6118	09 33 000 6218
	1.5	09 33 000 6116	09 33 000 6216
	2.5	09 33 000 6123	09 33 000 6223
	4	09 33 000 6119	09 33 000 6221



Conductor cross-section	Identification
0.14-0.37 mm ² AWG 26-22	no groove
0.5 mm ² AWG 20	no groove
0.75 mm ² AWG 18	1 groove*
1 mm ² AWG 18	1 groove
1.5 mm ² AWG 16	2 groove
2.5 mm ² AWG 14	3 groove
3 mm ² AWG 12	wide groove
4 mm ² AWG 12	no groove

* on the back crimp collar

Stripping length 7.5 mm

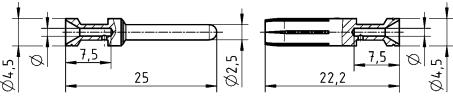

Conductor cross-section	Identification
0.14-0.37 mm ² AWG 26-22	no groove
0.5 mm ² AWG 20	no groove
0.75 mm ² AWG 18	1 groove*
1 mm ² AWG 18	1 groove
1.5 mm ² AWG 16	2 groove
2.5 mm ² AWG 14	3 groove
3 mm ² AWG 12	wide groove
4 mm ² AWG 12	no groove

* on the back crimp collar

Stripping length 7.5 mm