



Han® PushPull, type acc. to IEC 61 076-3-117 variant 14
Housing bulkhead mounting for device integration and RJ45 jacks

Features

- HARTING PushPull technology
- Compact design
- High packing density
- Device integration via RJ45 PCB connectors

Technical characteristics

Locking	PushPull technology acc. to IEC 61 076-3-117
Degree of protection	IP65 / IP67
Mating face	RJ45 acc. to IEC 60 603-7
Termination type	Jack with solder termination
Mating cycles	min. 750
Temperature range	-40 °C ... +70 °C
Housing material	Zinc die-cast, nickel plated

Identification

Part number

Drawing

Dimensions in mm

Components device side

Housing bulkhead mounting metal

09 35 002 0301

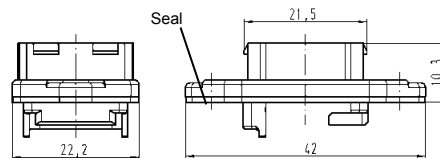

Protection cover IP65 / IP67

09 35 002 5402

Panel cut out

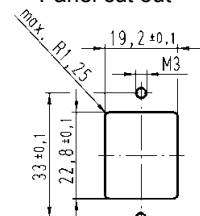

RJ45 jack

Solder variant, 90° angled

09 35 002 2101¹⁾

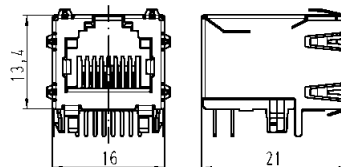

PCB layout

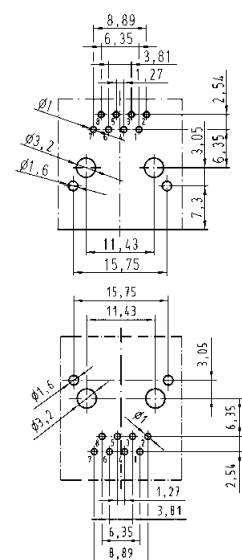

Solder variant, 180° straight

09 35 002 2102²⁾

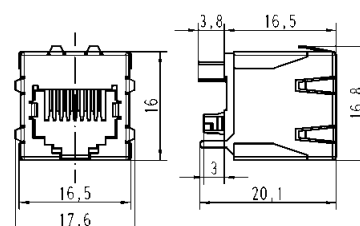

1) Packaging: Blister à 90 pieces
2) Packaging: Blister à 100 pieces